

PharmaFluidics μ PAC™ Grounding Cable

Ground it! with the μ PAC™ Grounding Cable

P/N: ACC-groundcable

If the μ PAC™ column is connected to the nanoESI source of a mass spectrometer, the column MUST be correctly grounded!

The μ PAC™ column is primarily composed of the semi-conductor silicon. If no precautions are taken to shunt the high voltage to ground, there is a dramatic chromatographic peak broadening effect. Grounding for three different electrospray ionisation configurations is shown in Figure 1.

Before applying high voltage to the nanoESI emitter, ground the μ PAC™ column. Attach the clip end of the blue coiled grounding cable to the μ PAC™ outlet union (*i.e.*, the stainless-steel union with a shallow groove). Via the swallow tail or crocodile clip, attach the other end of the grounding cable to a grounded point on the mass spectrometer or the chassis of the HPLC.

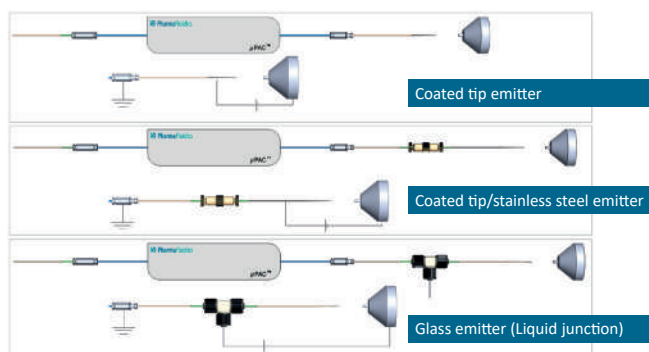

Figure 1: Grounded electrospray ionisation interfaces